

SPECIFICATION

- 规格
 1 Rating: DC 20V 7A;
 额定值: DC 20V 7A;
 2 Contact resistance: 0.03Ω;
 接触电阻: 0.03Ω;
 3 Insulation resistance: ≥100MΩ (DC250V);
 绝缘电阻: ≥100MΩ (DC250V);
 4 Withstand voltage: 500VAC
 耐压: 500VAC
 5 Insertion and extraction force 5-30N;
 插拔力: 5-30N;
 6 life test: 5000 cycles.
 寿命试验: 5000次循环。
 7 After plug is inserted, there is no instantaneous break in the up, down, left and right directions
 PLUG插入后上下左右4个方向无瞬断现象。

DC-C024E-7A-1.65

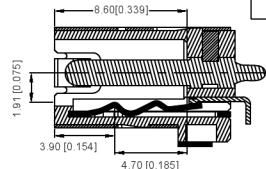
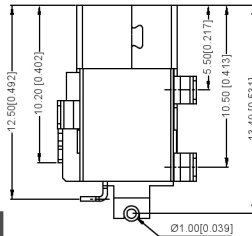
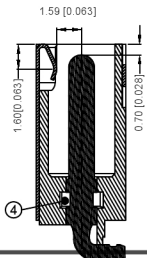

SECTION A-A

	MATERIAL	PLATING
center pin	Brass	tin
coat	Sus	
terminal 1	Phosphor Bronze	tin
terminal 2	Phosphor Bronze	tin
terminal 3	Phosphor Bronze	tin
plastic	Pa9t	

广东星坤科技股份有限公司

生	日期
效	
Δ	
Δ	
Δ	
MARK	DESCRIPTION
文件	工程章
REVISIONS	
DATE	REVISED
APPROVED	
UNSPECIFIED TOLERANCES	

ANGULAR	±5°
X.X	±0.2mm
X.XX	±0.1mm
X.XXX	±0.05mm

DSND	DATE	SCALE: N/A	MODEL TYPE: DC POWER JACK
DWN	DATE	VIEW: ①	PART NO.:
CHKD	DATE	UNIT: mm/in	DWG NO.:
APPD	DATE	SIZE: A4	DC-C024E-7A-1.65
XKB INDUSTRIAL PRECISION CO., LIMITED			WEIGHT SHEET REVISION 1.0g 1/1 A0